

Organic Resource Recovery

Smart solutions on a budget!



Compost Baladi

By: Marc Aoun

Who we are

Promote the sound management of organic waste using appropriate technologies that are tailored to local economic, social and environmental conditions



How does it differ from other waste?

Risks !

Odor from extended storage

Pest attraction from odor

Health & Safety Factor from Pest

WET &
SMELLY



Needs **frequent & specialized collection** to prevent issues

It all started as a blog and some boxes



User Feedback

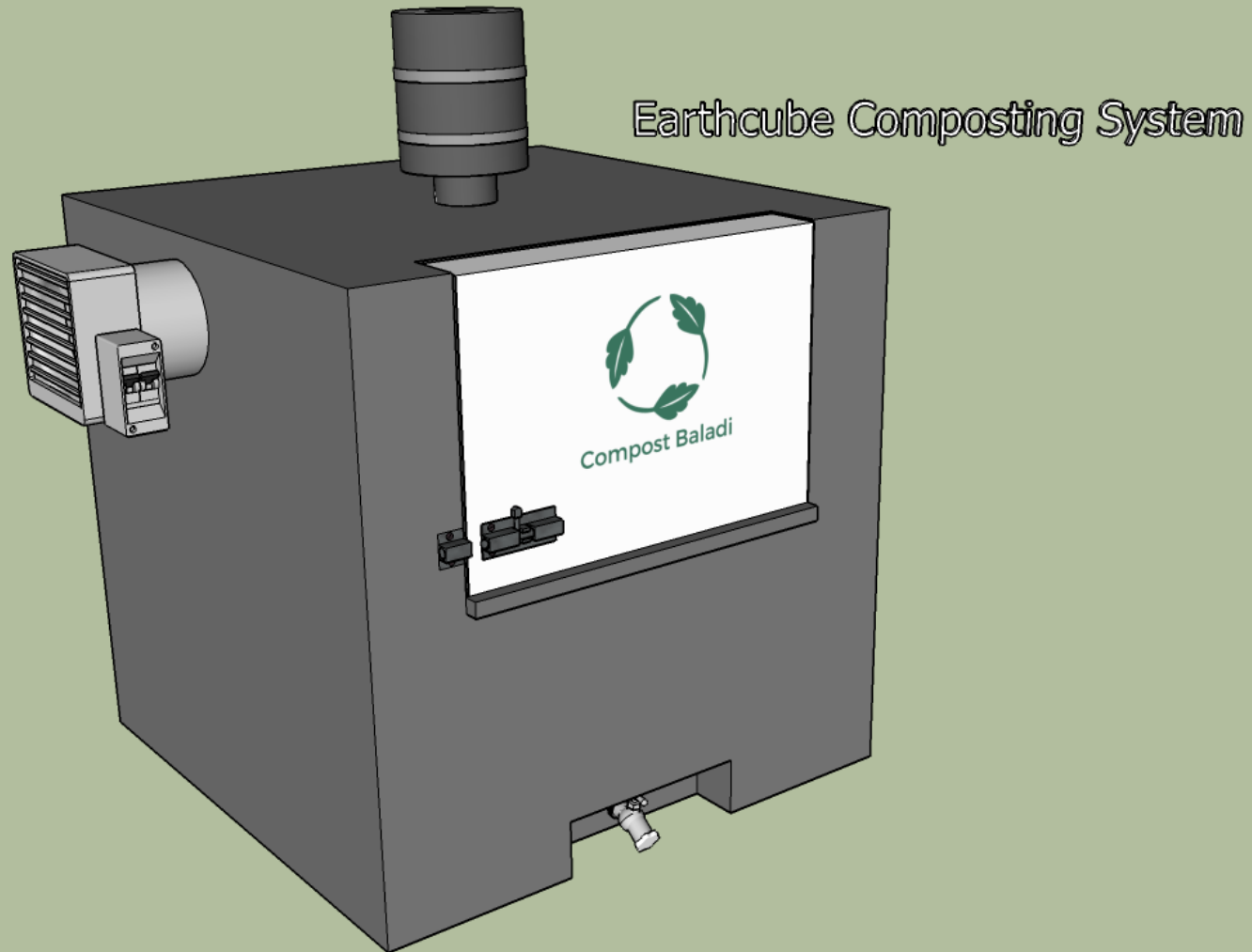

Earthcube system



Earthcube system



Household composting



Creating Value

STRATEGIC PLAN

“Black Gold” program

Compost Baladi SAL

Sin El Fil, Lebanon

+961 70 150 153
mrwaoun@gmail.com

Compost Baladi SAL Strategic Plan

Table of content

1. Executive Summary	3
2. Elevator Pitch.....	4
3. Program Mission Statement.....	5
4. SWOT Analysis.....	6
5. Goals.....	7
6. KPI's.....	8
7. Target Customers	9
8. Industry Analysis.....	10
9. Competitive Analysis & Advantage	11
10. Marketing Plan	12
11. Team	13
12. Operations Plan	14
13. Financial Projections.....	15

Who we deal with

- Households / Residential establishments
- Academic and Public Institutions
- Restaurants & Malls
- Food processors and Farmers
- Municipalities

Composting education



Fneideq school training



Earth festival workshop



Panel on the garbage crisis



Earth Hour Festival



Compost 101 - USEK



Compost workshop - SOILS



MAP association training



MakeSense Holdup

لكل البلديات وإتحاداتها

يلّي أبتد رغبة بإدارة نفاياتها الصلبة
رداً على تعميم وزارة البيئة رقم ١/١

شركتنا بتقدملكن

مجاناً

وحتى تاريخ ٣٠ نيسان، ٢٠١٨

دراسة علمية
للفرز من المصدر،
الفرز الثانوي، التدوير والتسبيخ

للإستعلام: 70 150 153

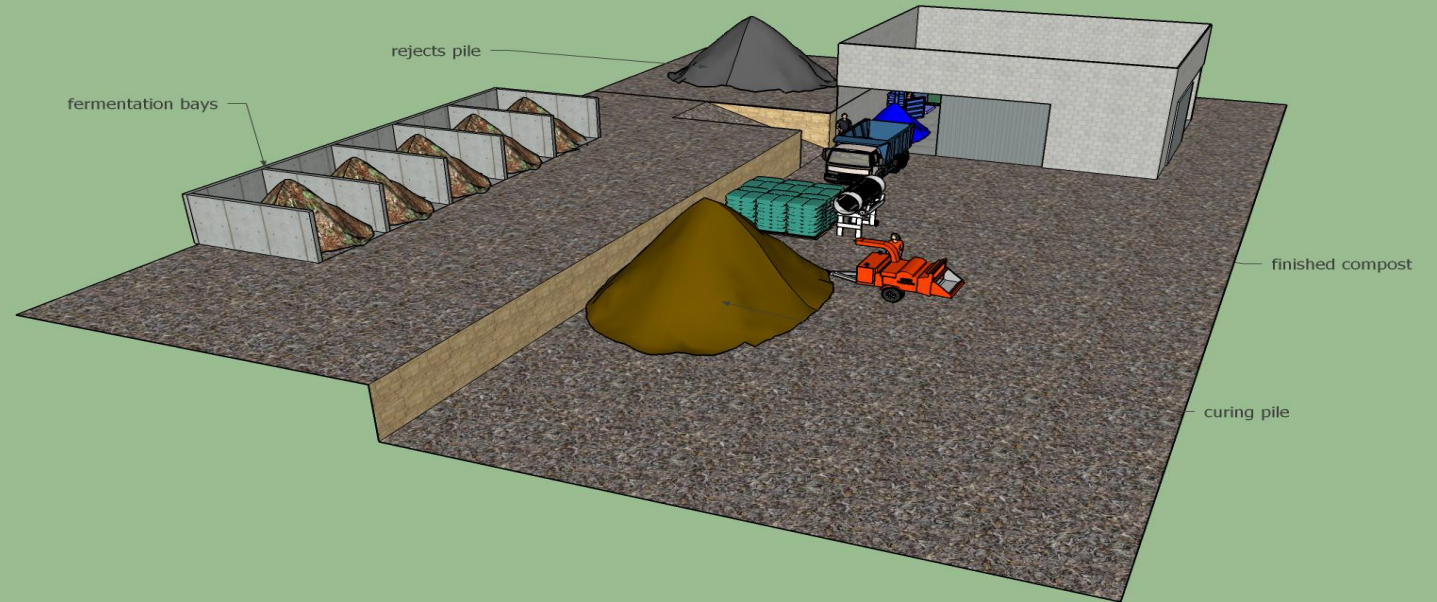
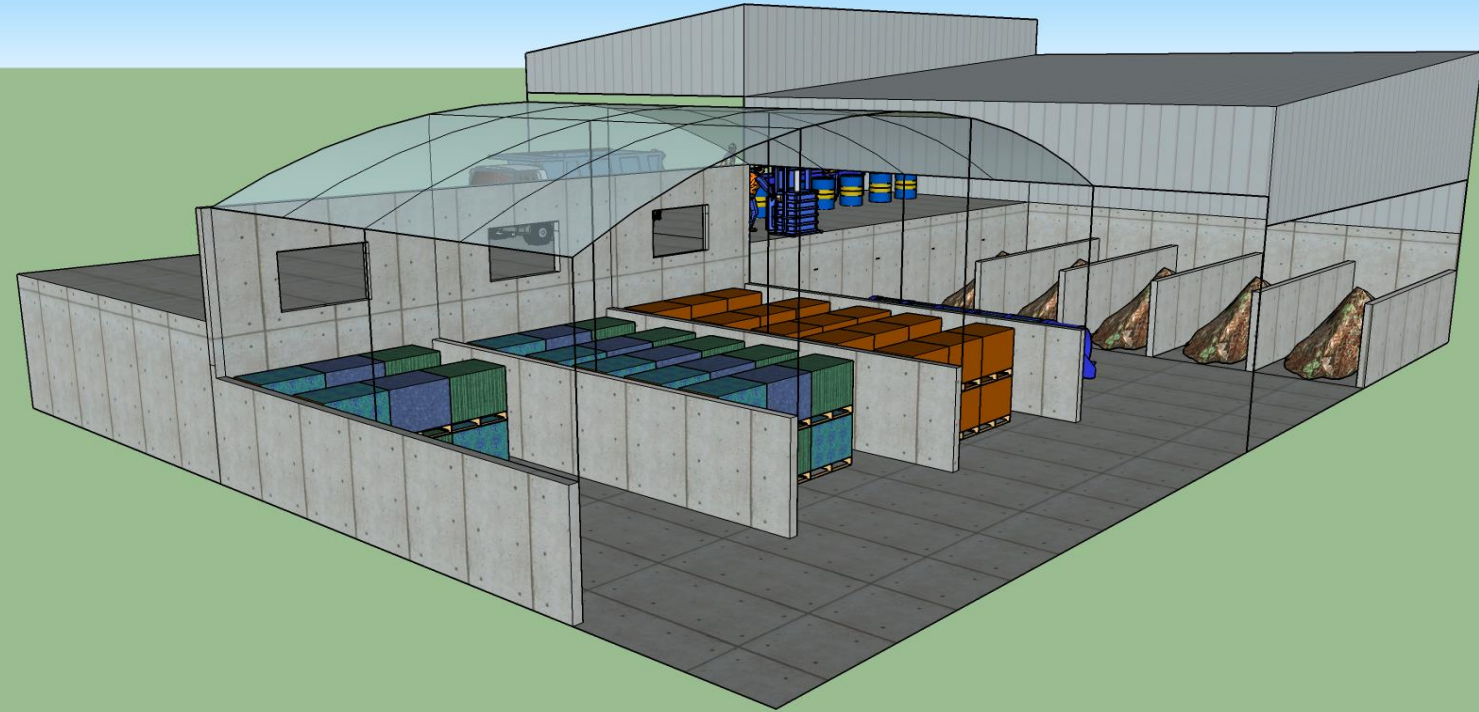

Collection and Material Recovery



Collection and Material Recovery



Compost Baladi Approach



Pros:

- Very low investment
- Only need bobcat
- No infrastructure
- Minor odor issues
- Low operational cost

Cons:

- Not an option for more than 3 tons per day
- Major leachate issues in winter if no cover
- Large footprint
- Require large amounts of carbon material (woodchips)

Compost Baladi Approach



Pros:

- Medium initial investment
- Reused material
- Modular, pre-assembled
- Temporary structure, no concrete
- Medium footprint
- Easy leachate management
- Odor control
- Low maintenance
- Does not require cover

Cons:

- Economical up to 10 tons per day
- Medium operational cost (electric demand for blowers)



Initial investment		PRICES IN USD
Transport	40,000	Not Included
Sorting at Source	121,000	Not Included
Secondary Sorting		81,100
Composting		114,600
Legal Documents		10,000
Consultation		20600
Sub-Total		226,300
Operational Cost		
Collection		110,000
Labor		43,200
Power consumption		17,000
Maintenance		3,800
materials		1,900
Consultation		10,000
Sub total		185,900
Operational cost per ton		46

WHAT IF NO LAND AVAILABLE

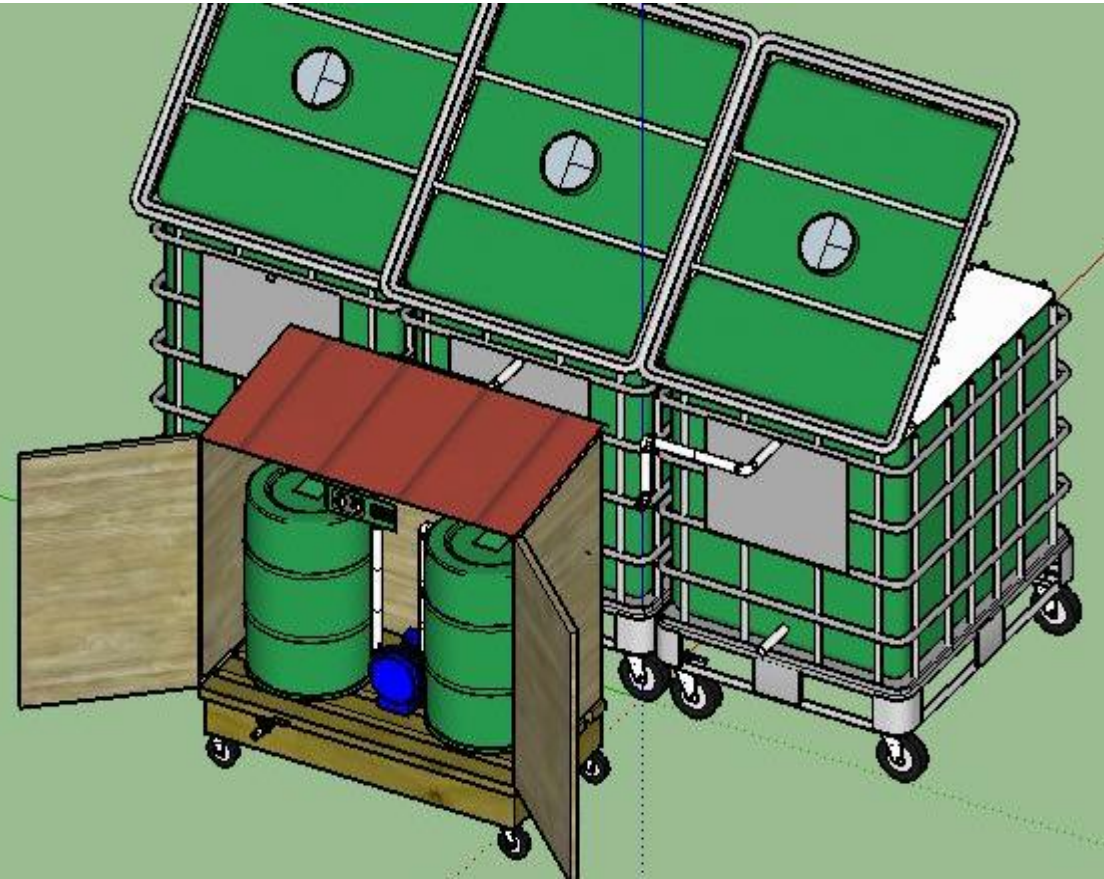

How it works

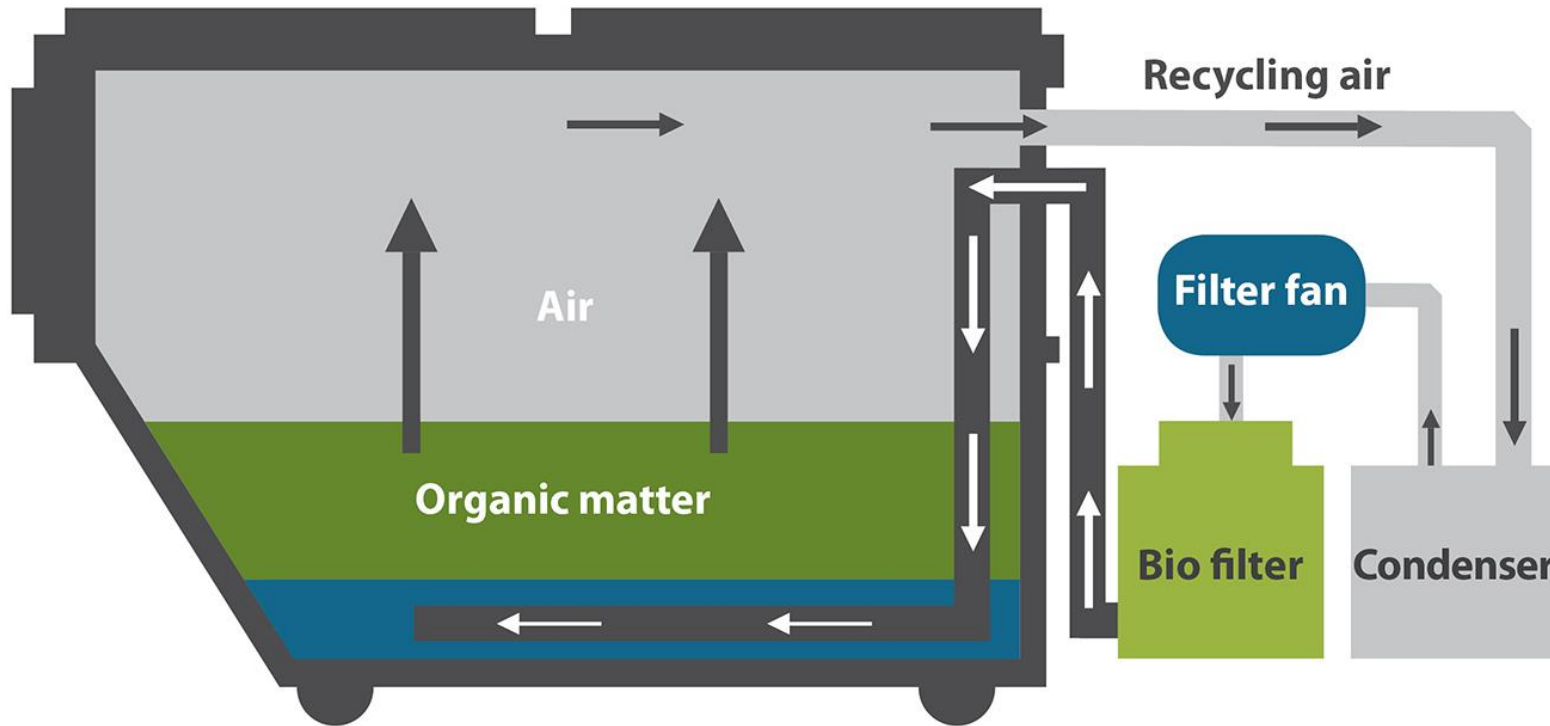

- Volume reduction
- Odor control
- Less transport
- Cost Saving
- Sustainable

What is even better than composting



What if the waste is rotten or manure?



But what about wood waste



What about wastewater

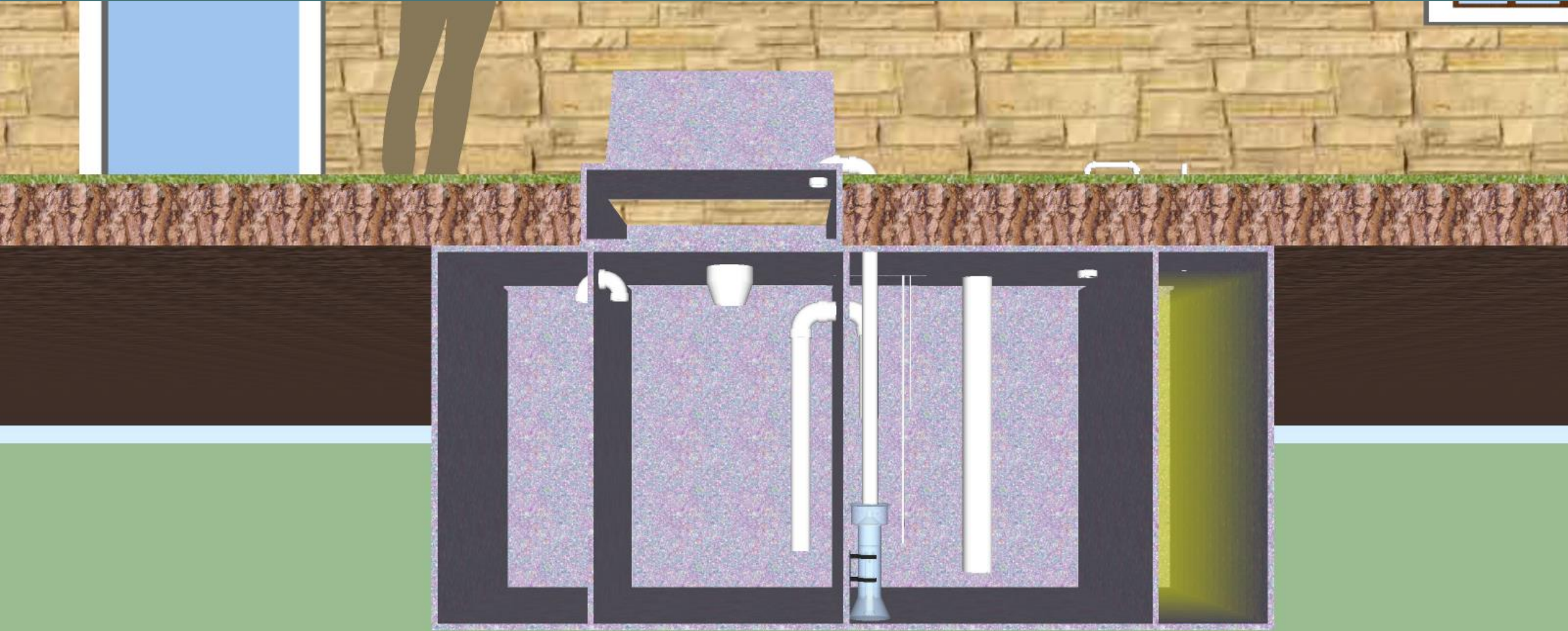

Project Achievements

**Dec
2017**

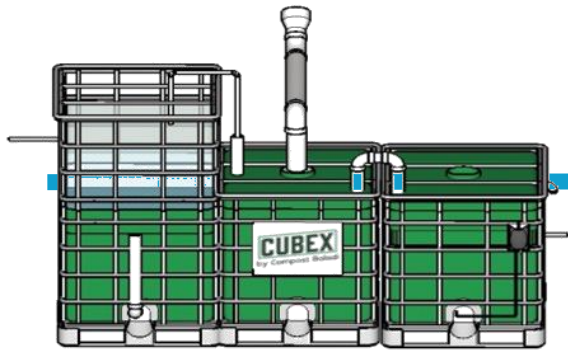

**March
2018**



**August
2018**



**November
2018**

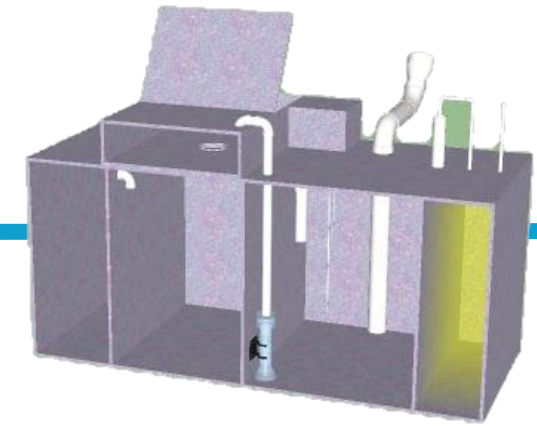

cewas



switchmed

Agrytech
Agri-food Innovation Hub



Thank You



Compost Baladi

Marc Aoun – *Co-Founder*

Mrwaoun@gmail.com

Mob: (+961) 70 150 153